

Overview

Here's what's shocking: A single square meter of solar panel can generate anywhere from 150 to 250 watts under ideal conditions. But "ideal" rarely exists in real life. Under optimal conditions (5 peak sun hours): At noon under direct sunlight: *Note: 1m². High-efficiency panels convert more sunlight into electricity, boosting overall output. By knowing W/m, you. The answer lies in something most solar salespeople never properly explain— solar irradiance and your actual energy potential per square meter. Sunlight Availability: Your Local Solar Fuel 2.

Efficiency of photovoltaic panels per square meter



Solar Panel Output per Square Meter: Efficiency Factors & Future ...

Discover how much electricity solar panels generate per square meter, explore efficiency factors, technology comparisons, and future innovations in photovoltaic energy.

[Get Price](#)

Solar panel efficiency calculator

Finally, it multiplies the efficiency ratio by 100 to convert it into a percentage. The tool displays the calculated efficiency in the results section. The efficiency percentage shows how well the solar panel ...

[Get Price](#)



Solar Energy Per Square Meter: How Much Power Can You Get?

This article explores solar energy per square meter and the various factors that influence energy output, such as location, climate, and panel efficiency. It provides crucial calculations, ...

[Get Price](#)



Solar Performance and Efficiency

The conversion efficiency of a photovoltaic (PV) cell, or solar cell, is the percentage of the solar energy shining on a PV device that is converted into usable electricity. Improving this conversion efficiency is ...



[Get Price](#)



Solar Power per Square Meter Calculator

Factors to Consider for Solar Panel Output Per Square Meter. Region: If you are living in countries near to poles, you will receive less sunlight. In comparison to the people living in regions ...

[Get Price](#)

Solar Energy Generation Per Square Metre: A Complete Guide

In this guide, we'll explore how much solar power can be harnessed per square metre, how solar panels work, the factors that impact their efficiency, and the home solar system cost.



[Get Price](#)

Solar Panel Watts Per Square Meter Explained



Learn how to measure solar panel efficiency using solar panel watts per square meter with this comprehensive guide.

[Get Price](#)

How Much Power Does 1 Square Meter of Photovoltaic Panels ...

Commercial panels typically convert 15%-22% of sunlight into electricity. For perspective: "A 20% efficient 1m² panel exposed to 1,000 W/m² sunlight generates 200W instant power." 3. Installation ...



[Get Price](#)

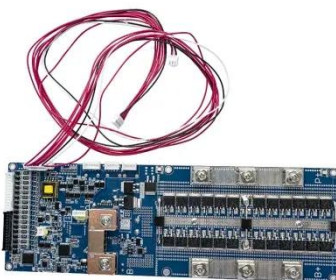

Solar Power Per Square Meter Calculator

Calculate solar panel energy output per square meter. Get accurate daily, monthly, and annual production estimates based on location, panel specs, and system losses.

[Get Price](#)

Understanding Solar Panel Efficiency

For example, if a panel receives 1000 watts per square meter of sunlight and converts 200 watts into electricity, it has an efficiency of 20%. Currently, the vast majority of commercial solar ...

[Get Price](#)

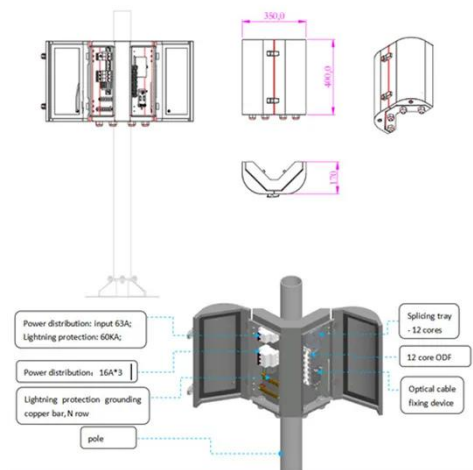

Solar Performance and Efficiency

In this guide, we'll explore how much solar power can be harnessed per square metre, how solar panels work, the factors that impact their efficiency, ...

[Get Price](#)

Contact Us

For catalog requests, pricing, or partnerships, please visit:
<https://www.pienaarshof.co.za>

