

PIENAAR ENERGY (PTY) LTD

Can I put a locker in the corridor outside the door



Overview

According to the National Fire Protection Association (NFPA) Life Safety Code, egress access corridors must be kept clear of obstructions at all times. This includes furniture, equipment, storage boxes, and any other items that could impede the flow of people during an. Items cannot be stored in corridors designated as egress access corridors no matter the width of the corridor. The exception are crash carts, which are considered permanently in-use emergency medical equipment, and carts containing PPE for isolation when associated for a specific patient (s), which. Because employees must have clear exit pathways or routes and enough space to exit a building in an emergency, the Occupational Safety and Health Administration (OSHA) and National Fire Protection Association (NFPA) require a minimum width for exit pathways. Any portion of a building that is open. While corridors are a seemingly not be used for any purpose other than convenient space to store items during an exit, may not be obstructed by any office moves or renovations, storing means, and any objects that project into materials in exit corridors creates a an exit route may not reduce the. Got a code question?

Just ask. I'm here to help you figure it out — no jargon, no hassle. Get Started with AI Navigator COPYRIGHT © 2026 INTERNATIONAL CODE COUNCIL, INC. ICC Digital Codes is the largest provider of. One of the biggest obstacles a person can encounter, preventing them from free egress, is a locked door. Approaching a noncompliant locked door unexpectedly and without the means necessary to operate it is an example of when egress becomes outside of an occupant's control.

Can I put a locker in the corridor outside the door



HEALTH & SAFETY Hallway Storage and Emergency Egress

m hallways can be directed to EH& S at 541-737-2273. Electronic equipment such as computers, computer displays, peripheral devices, lab equipment, and other electronics

[Get Price](#)

Can items be stored in areas designated as egress access corridors

According to the National Fire Protection Association (NFPA) Life Safety Code, egress access corridors must be kept clear of obstructions at all times. This includes furniture, equipment, ...



[Get Price](#)



Locker doors

Even though there are vents in the locker doors, there would be much slower or even no propagation of fire along the corridor via ignition of combustibles within the lockers. With the doors ...

[Get Price](#)

Permissible Egress Door Locking Arrangements , NFPA

When providing egress door locking arrangements, pay careful attention to the details for how to achieve the door locking safely and when and where these locking arrangements are permitted.

[Get Price](#)



HEAVY-DUTY CORRIDOR LOCKERS

Quiet-Plus Eliminating metal to metal contact, all Lyon locker doors are fitted with nylon lockbar guides to reduce clanging and provide smoother, quieter operation.

[Get Price](#)

Storage in Corridors and Exit Pathways

When items are stored in corridors, they often will be placed along the wall; however, important safety devices such as fire extinguishers, automated external defibrillator (AED) wall mounted units, some ...

[Get Price](#)

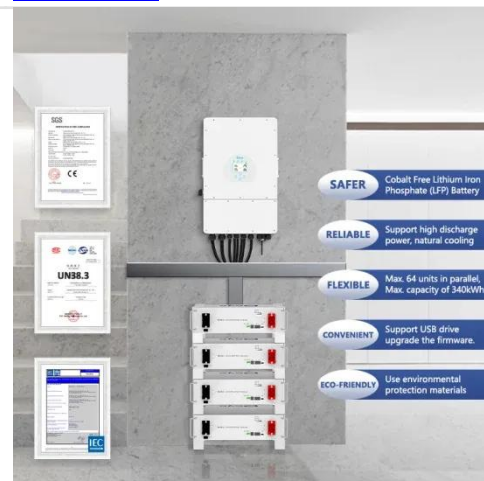

Storage in Corridors and Lobbies

Storage in metal lockers, provided the minimum required egress width is



maintained. Explore a searchable database of US construction and building code. Code regulations are consolidated by ...

[Get Price](#)

Means of Egress

Alcoves in corridors can be used for storage as long as the stored items do not project into the corridor. Dead-end corridors may be used for storage or sitting areas as long as it occupies ...

[Get Price](#)

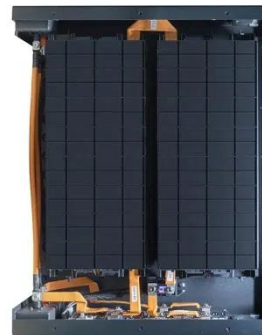

CHAPTER 10 MEANS OF EGRESS

Got a code question? Just ask. I'm here to help you figure it out -- no jargon, no hassle. Ask anything, and I'll do my best to get you what you need. Get Started with AI Navigator. COPYRIGHT © 2026 ...

[Get Price](#)

Contact Us

For catalog requests, pricing, or partnerships, please visit:
<https://www.pienaarshof.co.za>

